

5

4

3

2

1

| ITEM NO. | PART NUMBER | DESCRIPTION | QTY. |
|----------|-------------|-------------------------------------|------|
| 1 | 3-226/00 | ROUND HANDLE, GEORGIAN & BARCELONA | 1 |
| 1.1 | 92008 | SET SCREW, CUP POINT 8-32, 3/16" L. | 2 |
| 1.2 | P02013/00 | K141 COVER PLATE | 1 |
| 1.3 | P01015/00 | K110 HANDLE | 1 |
| 2 | 11087 | SLEEVE FOR PB-THERM PLATE | 1 |
| 3 | P17018/00 | PLATE, BEADED FOR PRESSURE BALANCE | 1 |
| 4 | P39001 | HEX KEY 5/64, FOR 8-32 SET SCREW | 1 |

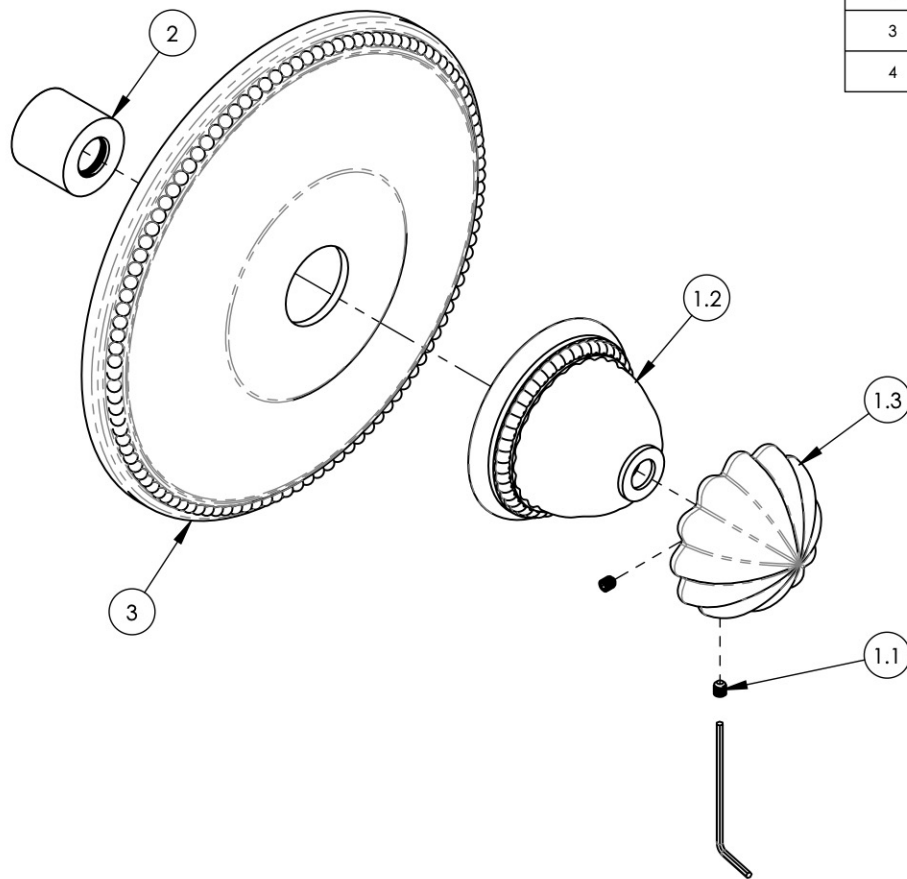

| ZONE | REV. | DESCRIPTION | DATE | APPROVED |
|-----------|------|-------------|------|----------|
| REVISIONS | | | | |

1261 LOGAN AVENUE
COSTA MESA, CALIFORNIA 92626
PHONE: 714.361.4800
FAX: 714.617.3120

PHYLIRICH®
Defining Luxury Since 1959

PROPRIETARY AND CONFIDENTIAL
THE INFORMATION CONTAINED IN THIS DRAWING IS THE SOLE PROPERTY OF PHYLIRICH. ANY REPRODUCTION IN PART OR AS A WHOLE WITHOUT THE WRITTEN PERMISSION OF PHYLIRICH IS PROHIBITED.

| | | | | |
|-----------------------------|---------|---|---|-----------------------|
| - | - | INTERPRET GEOMETRIC DIMENSIONING & TOLERANCING IN ACCORDANCE WITH ASME Y14.5-2009 & ASME Y14.41-2003 STANDARDS, UNLESS OTHERWISE SPECIFIED. DIMENSIONS ARE IN INCHES. TOLERANCES ARE: | | |
| NEXT ASSY | USED ON | FRACTIONS ±1/16" | DECIMALS X.X: ±.1 X.XX: ±.01 X.XXX: ±.005 | ANGULAR ±2° |
| APPLICATION | | MATERIAL | NAME | DATE |
| FINISH | | DRAWN | AMM | 7/13/2020 |
| DO NOT SCALE DRAWING | | CHECKED | AMM | 7/13/2020 |

THERM. SHOWER TRIM, ROUND HANDLE, GEORGIAN & BARCELONA

SIZE **A** ASM/PRT NO. **TH361/00** REV

SCALE: 1:2.5 WEIGHT: lbs. SHEET 1 OF 2

5

4

3

2

1