

- NOTE(S):  
 1. PART NUMBER, "/00" DENOTES PART SHALL HAVE FINISH.  
 2. APPLY NSF COMPLIANT GREASE TO ANY O-RING, SEALING JOINTS, AND/OR PIVOTAL POINTS.  
 3. APPLY NSF COMPLIANT LOCTITE TO THREADED AREA.

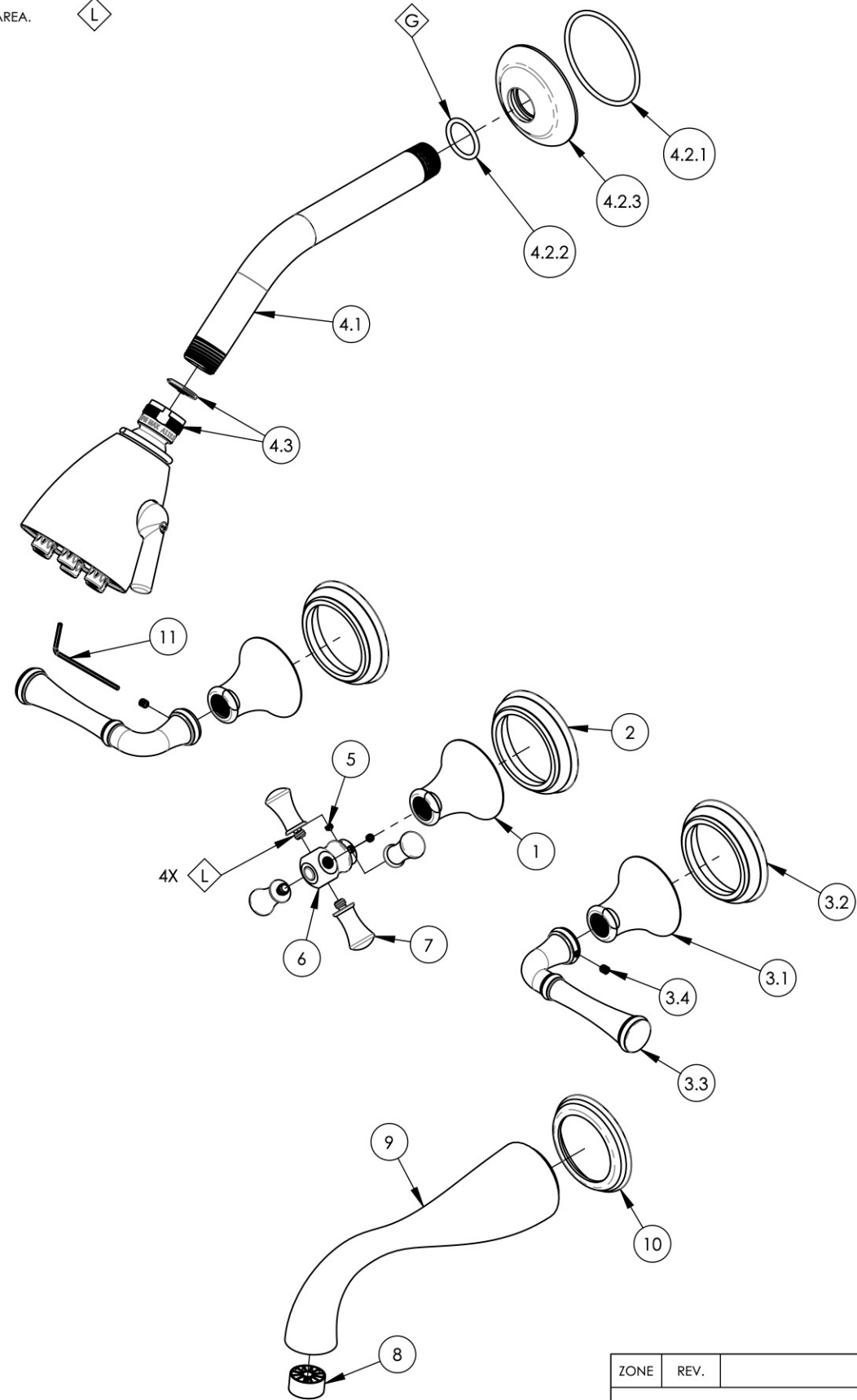

ITEM NO.	PART NUMBER	DESCRIPTION	QTY.
1	10972/00	HUB, TRANSITIONAL 3RING	1
2	11188/00	ESCUTCHEON, HANDLE BASE 3RING	1
3	3-475/00	ASSY. LEVER HANDLE, 3 RING SERIES	2
3.1	10972/00	HUB, TRANSITIONAL 3RING	1
3.2	11188/00	ESCUTCHEON, HANDLE BASE 3RING	1
3.3	P01079/00	HANDLE, STRAIGHT LEVER 3RING 205	1
3.4	92008	SET SCREW, CUP POINT 8-32, 3/16" L.	1
4	4-140/00	SHOWER HEAD 8" ARM, 6 JET PLUNGER, HEX TRADITIONAL	1
4.1	P16008/00	SHOWER ARM (8 INCH)	1
4.2	810/00	SHOWER FLANGE, TRADITIONAL	1
4.2.1	90138	O-RING, 2 1/8"ID X 3/32"THK., AS-568-138	1
4.2.2	90117	O-RING, 7/8"ID X 33/32"THK., AS-568-117	1
4.2.3	P16011/00	K803 SHOWER FLANGE	1
4.3	3-018/00	SHOWERHEAD SIX JET	1
5	92163	SET SCREW, CONE PT 8-32 X 1/8"L	2
6	P01056/00	D103 HANDLE BALL	1
7	P01057/00	SPOKE FOR HANDLE, D103	4
8	P03061	#CH-101-6 PLTC WTR STNR FOR SPOUT	1
9	P26001/00	DORALFE WALL TUB SPOUT	1
10	P26018/00	ESCUTCHEON BASE, 3RING WALL SPOUT	1
11	P39001	HEX KEY 5/64, FOR 8-32 SET SCREW	1

ZONE	REV.	DESCRIPTION	DATE	APPROVED	
REVISIONS					
1261 LOGAN AVENUE COSTA MESA, CALIFORNIA 92626 PHONE: 714.361.4800 FAX: 714.617.3120		<b>PHYLIRICH</b> Defining Luxury Since 1959	<b>PROPRIETARY AND CONFIDENTIAL</b> THE INFORMATION CONTAINED IN THIS DRAWING IS THE SOLE PROPERTY OF PHYLIRICH. ANY REPRODUCTION IN PART OR AS A WHOLE WITHOUT THE WRITTEN PERMISSION OF PHYLIRICH IS PROHIBITED.		

-	-	INTERPRET GEOMETRIC DIMENSIONING & TOLERANCING IN ACCORDANCE WITH ASME Y14.5-2009 & ASME Y14.41-2003 STANDARDS. UNLESS OTHERWISE SPECIFIED, DIMENSIONS ARE IN INCHES. TOLERANCES ARE:		
NEXT ASSY	USED ON	<b>FRACTIONS</b> ±1/16"	<b>DECIMALS</b> X.X: ±.1 X.XX: ±.01 X.XXX: ±.005	<b>ANGULAR</b> ±2°
APPLICATION		MATERIAL	NAME	DATE
FINISH		DRAWN	AMM	4/14/2020
<b>DO NOT SCALE DRAWING</b>		CHECKED		

<b>THREE HANDLE TUB AND SHOWER SET, STRAIGHT LEVER, 3 RING</b>		
SIZE	ASM/PRT NO.	REV
<b>B</b>	D2205/00	-
SCALE: 1:3.5	WEIGHT: lbs.	SHEET 1 OF 2