

NOTE(S):  
 1. APPLY NSF COMPLIANT GREASE TO ANY O-RING, SEALING JOINTS, AND/OR PIVOTAL POINTS.

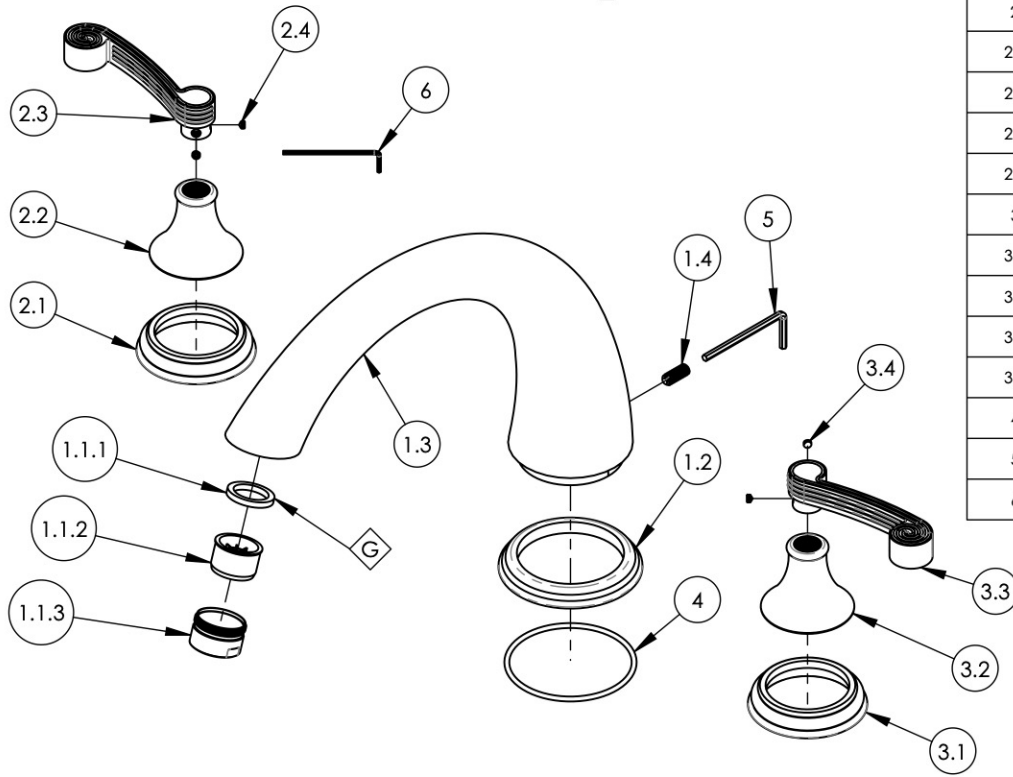

ITEM NO.	PART NUMBER	DESCRIPTION	QTY.
1	3-197/00	DECK TUB SPOUT, P27020 (K5120) CARRARA, REVERE SERIES	1
1.1	3-610/00	AERATOR & HOUSING, M28X1, TUB FILLER, FULL FLOW	1
1.1.1	10584	RUBBER SEAL, AERATOR GASKET 1.0"OD X .753"ID X .125"THK	1
1.1.2	10582	AERATOR, NEOSTRAHL. M28, TUB FILLER, FULL FLOW	1
1.1.3	10583/00	AERATOR HOUSING, M28 41.2007.000	1
1.2	P27035/00	ESCUTCHEON BASE, 3RING DECK SPOUT	1
1.3	P27020/00	K5120 DECK SPOUT	1
1.4	92262	SET SCREW, CUP PT 1/4"-20 X 5/8"L	1
2	3-476/00	ASSY. LEFT CURVED LEVER HANDLE, 3 RING SERIES	1
2.1	11188/00	ESCUTCHEON, HANDLE BASE 3RING	1
2.2	10972/00	HUB, TRANSITIONAL 3RING	1
2.3	P01082	3 RING CURVED HANDLE, LEFT	1
2.4	92163	SET SCREW, CONE PT 8-32 X 1/8"L	2
3	3-477/00	ASSY. RIGHT CURVED LEVER HANDLE, 3 RING SERIES	1
3.1	11188/00	ESCUTCHEON, HANDLE BASE 3RING	1
3.2	10972/00	HUB, TRANSITIONAL 3RING	1
3.3	P01080	3 RING CURVED HANDLE, RIGHT	1
3.4	92163	SET SCREW, CONE PT 8-32 X 1/8"L	2
4	90145	O-RING, 2-9/16"ID X 3/32"THK., AS-568-145	1
5	92216	HEX L-KEY 1/8" HEX x 2-5/16"L	1
6	P39001	HEX KEY 5/64, FOR 8-32 SET SCREW	1

ALL	A	REMOVE VALVES/ ROUGH IN, UPDATE TEMPLATE, ADD CALL OUTS & HANDLE/SPOUT SUBASSYS	4/14/2020	AMM
ZONE	REV.	DESCRIPTION	DATE	APPROVED
REVISIONS				

1261 LOGAN AVENUE  
 COSTA MESA, CALIFORNIA 92626  
 PHONE: 714.361.4800  
 FAX: 714.617.3120

**PHYL RICH**<sup>®</sup>  
 Defining Luxury Since 1959

**PROPRIETARY AND CONFIDENTIAL**  
 THE INFORMATION CONTAINED IN THIS DRAWING IS THE SOLE PROPERTY OF PHYL RICH. ANY REPRODUCTION IN PART OR AS A WHOLE WITHOUT THE WRITTEN PERMISSION OF PHYL RICH IS PROHIBITED.

-	-	INTERPRET GEOMETRIC DIMENSIONING & TOLERANCING IN ACCORDANCE WITH ASME Y14.5-2009 & ASME Y14.41-2003 STANDARDS, UNLESS OTHERWISE SPECIFIED. DIMENSIONS ARE IN INCHES. TOLERANCES ARE:		
NEXT ASSY	USED ON	FRACTIONS ±1/16"	DECIMALS X.X: ±.1 X.XX: ±.01 X.XXX: ±.005	ANGULAR ±2°
APPLICATION		MATERIAL	NAME	DATE
FINISH		DRAWN	CA	9/23/2013
DO NOT SCALE DRAWING		CHECKED		

**ROMAN TUB SET, 3RING SERIES, CURVED LEVER (205-41/00)**

SIZE **A** ASM/PRT NO. **D1206E/00** REV **A**

SCALE: 1:4 WEIGHT: lbs. SHEET 1 OF 2