

ITEM NO.	PART NUMBER	DESCRIPTION	QTY.
1	3-197/00	DECK TUB SPOUT, P27020 (K5120) CARRARA, REVERE SERIES	1
1.1	3-610/00	AERATOR & HOUSING, M28X1, TUB FILLER, FULL FLOW	1
1.1.1	10584	RUBBER SEAL, AERATOR GASKET 1.0"OD X .753"ID X .125"THK	1
1.1.2	10582	AERATOR, NEOSTRAHL. M28, TUB FILLER, FULL FLOW	1
1.1.3	10583/00	AERATOR HOUSING, M28 41.2007.000	1
1.2	P27035/00	ESCUTCHEON BASE, 3RING DECK SPOUT	1
1.3	P27020/00	K5120 DECK SPOUT	1
1.4	92262	SET SCREW, CUP PT 1/4"-20 X 5/8"L	1
1.5	90145	O-RING, 2-9/16"ID X 3/32"THK., AS-568-145	1
2	3-470/00	ASSY. LEVER HANDLE, REVERE & SAVANNAH	2
2.1	P01032/00	K160 LEVER FOR HANDLE	1
2.2	P01031/00	K160 D100 BALL FOR HANDLE, HUB	1
2.3	P02004/00	K190X2 COVER PLATE	1
2.4	92163	SET SCREW, CONE PT 8-32 X 1/8"L	2
3	92216	HEX L-KEY 1/8" HEX x 2-5/16"L	1
4	P39001	5/64 HEX KEY	1

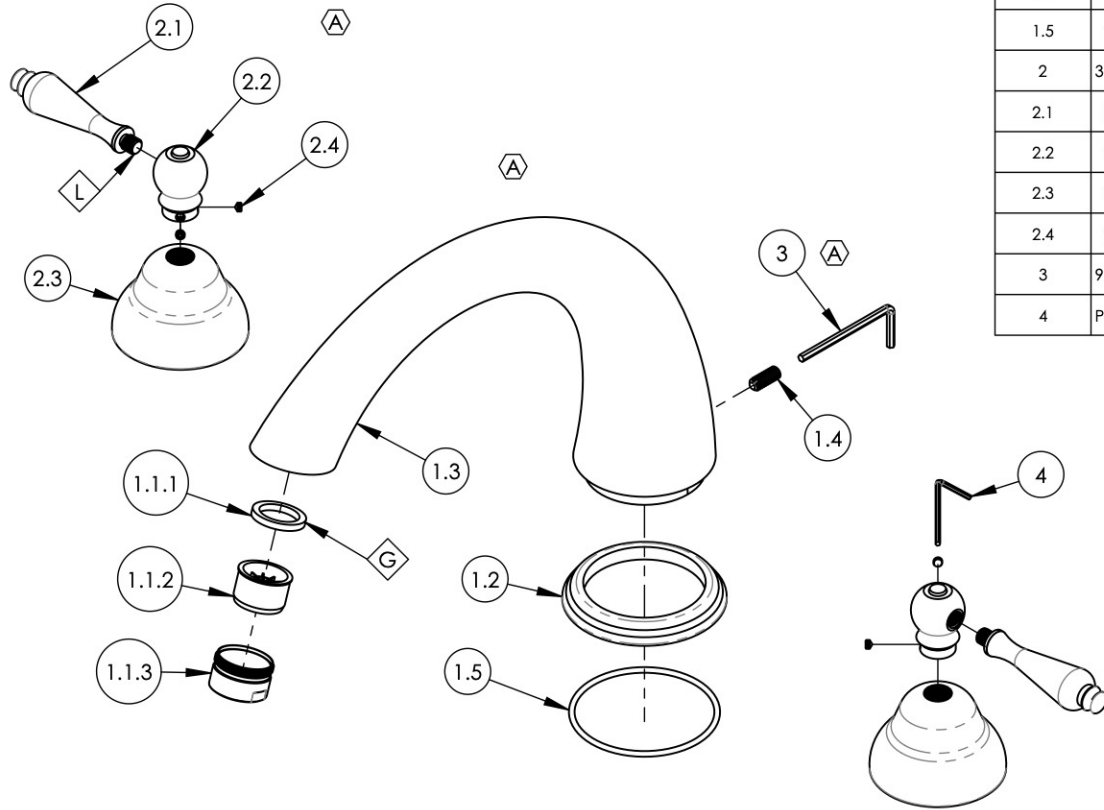

- NOTE(S):
1. APPLY NSF COMPLIANT GREASE TO ANY O-RING, SEALING JOINTS, AND/OR PIVOTAL POINTS. G
 2. APPLY NSF COMPLIANT LOCTITE TO THREADED AREA. L

ALL	A	UPDATE TEMPLATE/ HEX KEY, ADD SUBASSYS, REMOVE ROUGH IN/VALVES	6/19/2020	AMM
ZONE	REV.	DESCRIPTION	DATE	APPROVED
REVISIONS				

1261 LOGAN AVENUE
COSTA MESA, CALIFORNIA 92626
PHONE: 714.361.4800
FAX: 714.617.3120

PHYLIRICH[®]
Defining Luxury Since 1959

PROPRIETARY AND CONFIDENTIAL
THE INFORMATION CONTAINED IN THIS DRAWING IS THE SOLE PROPERTY OF PHYLIRICH. ANY REPRODUCTION IN PART OR AS A WHOLE WITHOUT THE WRITTEN PERMISSION OF PHYLIRICH IS PROHIBITED.

-	-	INTERPRET GEOMETRIC DIMENSIONING & TOLERANCING IN ACCORDANCE WITH ASME Y14.5-2009 & ASME Y14.41-2003 STANDARDS, UNLESS OTHERWISE SPECIFIED. DIMENSIONS ARE IN INCHES. TOLERANCES ARE:		
NEXT ASSY	USED ON	FRACTIONS ±1/16"	DECIMALS X.X: ±.1 X.XX: ±.01 X.XXX: ±.005	ANGULAR ±2°
APPLICATION		MATERIAL	NAME	DATE
FINISH		DRAWN	CA	10/15/2013
DO NOT SCALE DRAWING		CHECKED		

ROMAN TUB SET, STRAIGHT LEVER, REVERE & SAVANNAH (100-40/00)

SIZE	ASM/PRT NO.	REV
A	D1200T/00	A
SCALE: 1:3.5	WEIGHT: lbs.	SHEET 1 OF 2