

NOTE(S):
 1. PART NUMBER, "/00" DENOTES PART SHALL HAVE FINISH.

2. APPLY NSF COMPLIANT GREASE TO ANY O-RING, SEALING JOINTS, AND/OR PIVOTAL POINTS.

3. APPLY NSF COMPLIANT LOCTITE TO THREADED AREA.

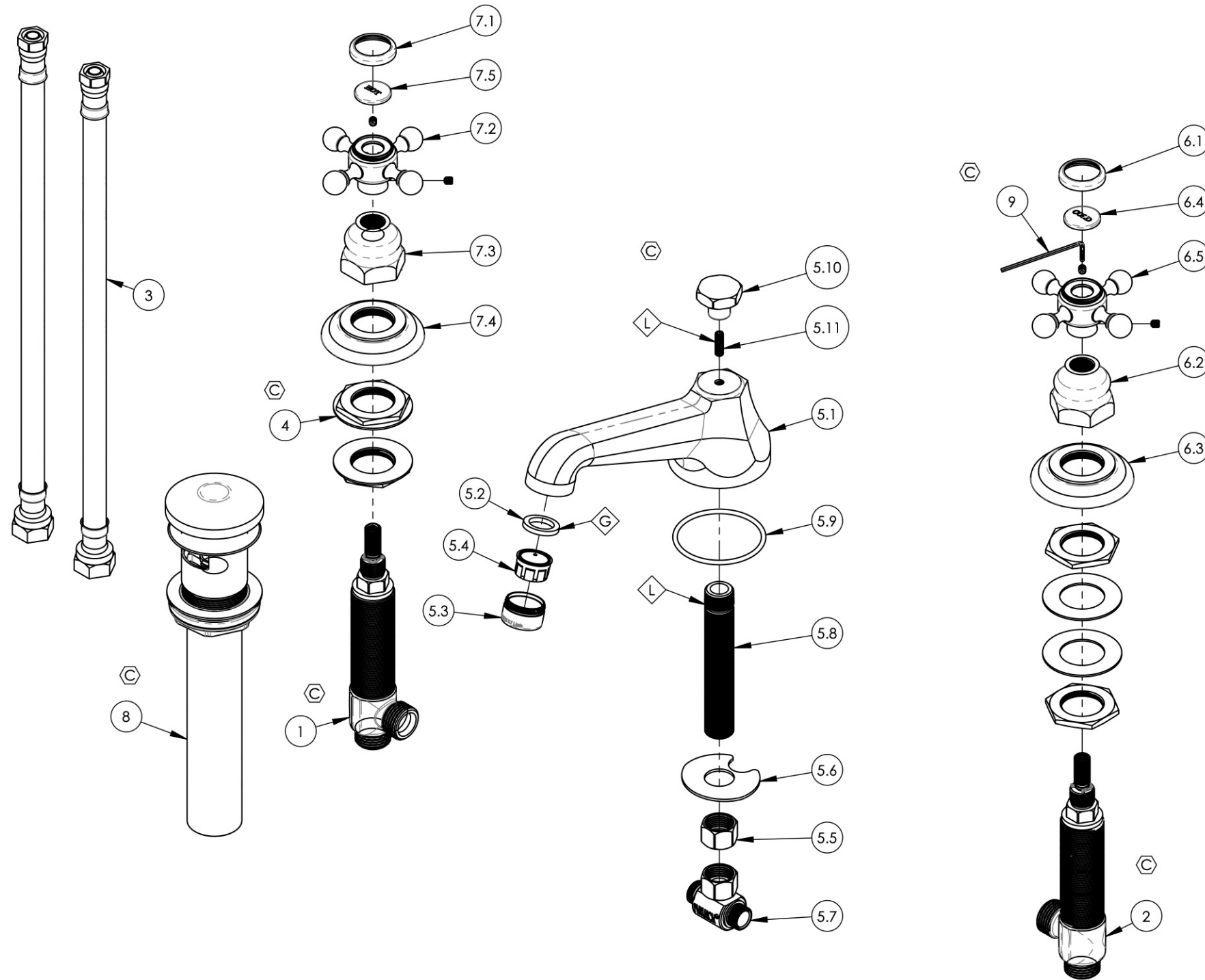

| ITEM NO. | PART NUMBER | DESCRIPTION | QTY. |
|----------|-------------|---|------|
| 1 | 1-149 | WIDESPREAD VALVE LAV 16PT, HOT, ONLY | 1 |
| 2 | 1-150 | WIDESPREAD VALVE LAV 16PT, COLD, ONLY | 1 |
| 3 | 10982 | HOSE, 3/8" COMP. X 1/2" NPSM - 12'L | 2 |
| 4 | 2-203 | MOUNTING NUT KIT, WIDESPREAD LAV | 4 |
| 5 | 3-134/00 | SPOUT ONLY WIDESPREAD LAV, HEX MOD./TRAD. | 1 |
| 5.1 | 10919 | SPOUT LOW LAV, HEX MODERN | 1 |
| 5.2 | 30030 | RUBBER SEAL WASHER AERATOR, NEOPERL PRT # BW.7110.1 | 1 |
| 5.3 | 30032/00 | AERATOR HOUSING 15/16" MALE HOUSING | 1 |
| 5.4 | 11426 | AERATOR DROP-IN INSERT 1.2 GPM, NEOPERL # 40.2060.00000 | 1 |
| 5.5 | 10746 | NUT, 3/8"-18 NPSL | 1 |
| 5.6 | 92174 | WASHER MOUNT WIDESPREAD (3/8") | 1 |
| 5.7 | 1-112 | TEE VALVE, 3/8" NPSM X 3/8" COMPRESSION | 1 |
| 5.8 | 10745 | THREAD ALL, 3/8"-18 NPSL - 3/8"NPT | 1 |
| 5.9 | 90135 | O-RING, 1-15/16"ID X 3/32"THK, AS-568-135 | 1 |
| 5.10 | 10920/00 | POP-UP KNOB, HEX TRADITIONAL | 1 |
| 5.11 | 92152 | SET SCREW, CUP PT. 10-24 UNC X 5/8"L | 1 |
| 6 | 3-141C/00 | CROSS HANDLE, HEX TRADITIONAL, 500 SERIES | 1 |
| 6.1 | 10538/00 | CAP RING FOR 500 SERIES BUTTON | 1 |
| 6.2 | 10621/00 | BASE HUB NUT | 1 |
| 6.3 | 10619/00 | ESCUTCHEON, TRADITIONAL LAV 1"-20 | 1 |
| 6.4 | 11098 | PLASTIC BUTTON, COLD | 1 |
| 6.5 | 2-180/00 | SUB ASSY. CROSS HANDLE HUB | 1 |
| 7 | 3-141H/00 | CROSS HANDLE, HEX TRADITIONAL, 500 SERIES | 1 |
| 7.1 | 10538/00 | CAP RING FOR 500 SERIES BUTTON | 1 |
| 7.2 | 2-180/00 | SUB ASSY. CROSS HANDLE HUB | 1 |
| 7.3 | 10621/00 | BASE HUB NUT | 1 |
| 7.4 | 10619/00 | ESCUTCHEON, TRADITIONAL LAV 1"-20 | 1 |
| 7.5 | 11099 | PLASTIC BUTTON, HOT | 1 |
| 8 | 3-545/00 | BRASS PUSH TYPE DRAIN, W/ OVERFLOW & SMALL PLUG | 1 |
| 9 | P39001 | HEX KEY 5/64, FOR 8-32 SET SCREW | 1 |

| ALL | C | UPDATE TEMPLATE, DWG NAME, VALVES/MOUNTING NUTS, SPOUT ASSY & DRAIN, ADD HEX KEY | 5/27/2020 | AMM |
|--|------|--|-----------|----------|
| ZONE | REV. | DESCRIPTION | DATE | APPROVED |
| REVISIONS | | | | |
| 1261 LOGAN AVENUE COSTA MESA, CALIFORNIA 92626 PHONE: 714.361.4800 FAX: 714.617.3120 | | PHYLIRICH Defining Luxury Since 1959 | | |
| PROPRIETARY AND CONFIDENTIAL | | | | |
| THE INFORMATION CONTAINED IN THIS DRAWING IS THE SOLE PROPERTY OF PHYLIRICH. ANY REPRODUCTION IN PART OR AS A WHOLE WITHOUT THE WRITTEN PERMISSION OF PHYLIRICH IS PROHIBITED. | | | | |

| | | | |
|---|----------------------------|---|-----------------------|
| INTERPRET GEOMETRIC DIMENSIONING & TOLERANCING IN ACCORDANCE WITH ASME Y14.5-2009 & ASME Y14.41-2003 STANDARDS. UNLESS OTHERWISE SPECIFIED, DIMENSIONS ARE IN INCHES. TOLERANCES ARE: | FRACTIONS ±1/16" | DECIMALS X.X: ±.1 X.XX: ±.01 X.XXX: ±.005 | ANGULAR ±2° |
| NEXT ASSY | USED ON | APPLICATION | |
| MATERIAL | FINISH | DRAWN | DATE |
| DO NOT SCALE DRAWING | CHECKED | GRE | 1/27/2014 |

| | | |
|--|--------------|--------------|
| WIDESPREAD LAV, LOW SPOUT W/ CROSS, HEX TRADITIONAL | | |
| SIZE | ASM/PRT NO. | REV |
| B | 500-01/00 | C |
| SCALE: 1:3 | WEIGHT: lbs. | SHEET 1 OF 2 |