

5

4

3

2

1

NOTE(S):

- 1. APPLY NSF COMPLIANT LOCTITE TO THREADED AREA.



ITEM NO.	PART NUMBER	DESCRIPTION	QTY.
1	3-125/00	EXTENSION ASSY FOR PB TUB & SHOWER SET	1
1.1	11008/00	DIVERTED STEM FOR PB PLATE	1
1.2	11006/00	PULL KNOB, DIVERTER, 10-24	1
1.3	P17066/00	EXTENSION SLEEVE, STEM, PB TUB & SHOWER SET	1
1.4	30133	EXTENSION, THEAD NUT ADAPTOR	1
2	3-340/00	ASSY, HANDLE & ESCUTCHEON COURONNE SERIES	1
2.1	2-038/00	ASSY, HANDLE & ESCUTCHEON COURONNE SERIES	1
2.2	11175/00	ESCUTCHEON, COURONNE SERIES	1
2.3	92008	SET SCREW, CUP POINT 8-32, 3/16" L.	1
2.4	11160/00	FINIAL BALL, TOP CROWN	1
3	10516/00	TRIM PLATE DIVERTED, FRENCH TRAD. PB/THERMO	1
4	11087	SLEEVE FOR PB-THERM PLATE	1

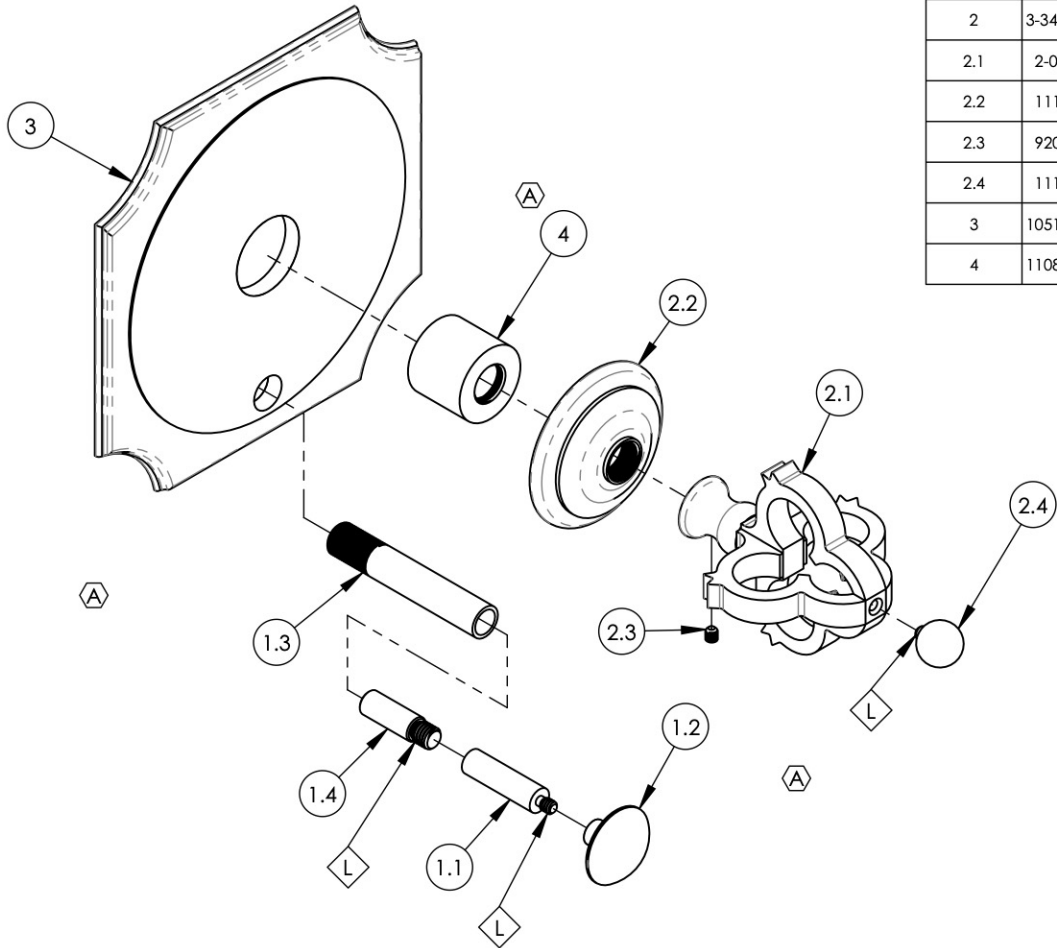

ALL	A	UPDATE TEMPLATE/ SLEEVE MOUNT, REMOVE TAPE & HEX KEY, ADD CALL OUTS	7/30/2020	AMM
ZONE	REV.	DESCRIPTION	DATE	APPROVED
REVISIONS				

1261 LOGAN AVENUE
COSTA MESA, CALIFORNIA 92626
PHONE: 714.361.4800
FAX: 714.617.3120

PHYLIRICH[®]
Defining Luxury Since 1959

PROPRIETARY AND CONFIDENTIAL
THE INFORMATION CONTAINED IN THIS DRAWING IS THE SOLE PROPERTY OF PHYLIRICH. ANY REPRODUCTION IN PART OR AS A WHOLE WITHOUT THE WRITTEN PERMISSION OF PHYLIRICH IS PROHIBITED.

-		-		INTERPRET GEOMETRIC DIMENSIONING & TOLERANCING IN ACCORDANCE WITH ASME Y14.5-2009 & ASME Y14.41-2003 STANDARDS, UNLESS OTHERWISE SPECIFIED. DIMENSIONS ARE IN INCHES. TOLERANCES ARE: FRACTIONS ±1/16" DECIMALS X.X: ±.1 X.XX: ±.01 X.XXX: ±.005 ANGULAR ±2°
NEXT ASSY		USED ON		
APPLICATION				
MATERIAL		NAME	DATE	
FINISH		DRAWN	LLO	10/21/2015
DO NOT SCALE DRAWING		CHECKED	GRE	

**PRESSURE BALANCE SHOWER PLATE W/
DIVERTER & HANDLE TRIM SET,
COURONNE**

SIZE	ASM/PRT NO.	REV
A	4-473/00	A

SCALE: 1:2.5 WEIGHT: lbs. SHEET 1 OF 2

5

4

3

2

1