

- NOTE(S):
- PART NUMBER, "/00" DENOTES PART SHALL HAVE FINISH.
 - APPLY NSF COMPLIANT GREASE TO ANY O-RING, SEALING JOINTS, AND/OR PIVOTAL POINTS.
 - APPLY NSF COMPLIANT LOCTITE TO THREADED AREA.
 - APPLY NSF COMPLIANT REMOVABLE (BLUE) LOCTITE TO THREADED AREA.
 - SILVER SOLDER JOINTS SHALL BE FULLY WETTED VIA CAPILLARY ACTION AND COMPLETELY NON-POROUS.

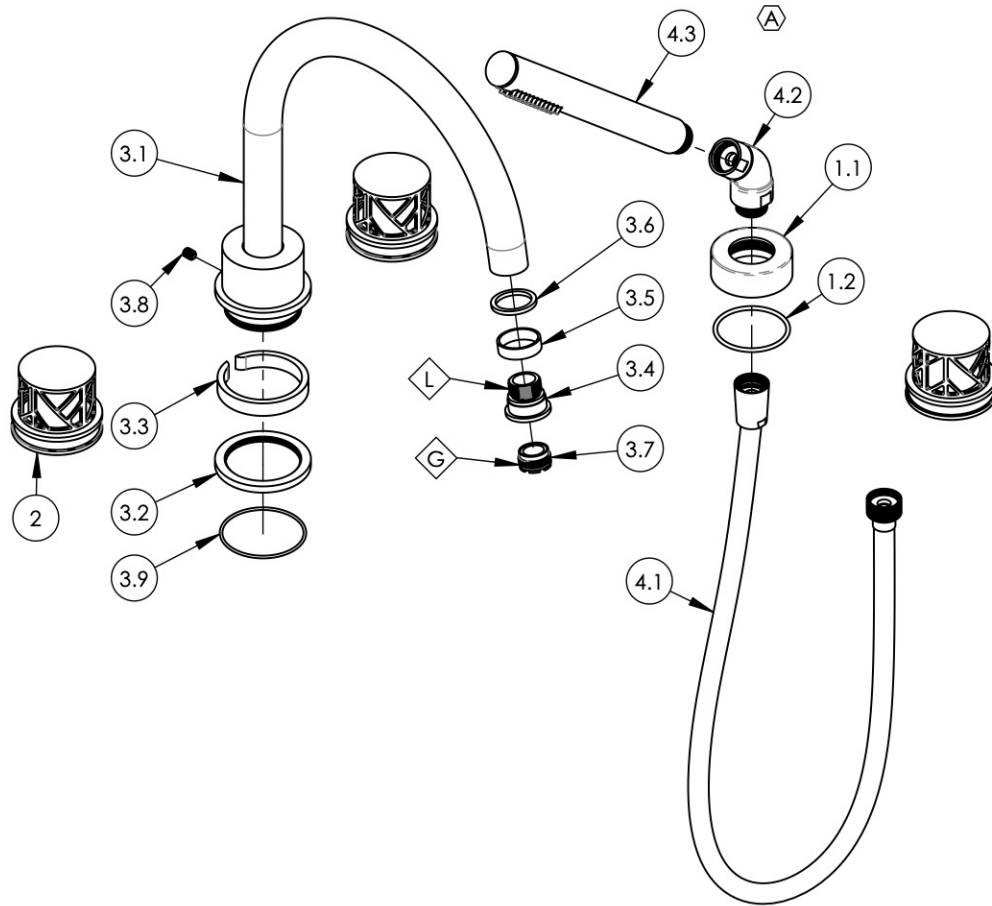

ITEM NO.	PART NUMBER	DESCRIPTION	QTY.
1	3-216/00	ESCUTCHEON BASE, HANDSHOWER, ROND	1
1.1	11760/00	ESCUTCHEON, HAND SHOWER, ROND	1
1.2	90133	1 13/16" O-RING, 1-13/16 ID X 3/32 THK, AS-568-133	1
2	3-605/00	ASSY, ROUND HANDLE & BASE, CAGE DESIGN, JOLIE	3
1.1	3-640/00	ASSY, DECK TUB SPOUT & BASE, ROUND, JOLIE	1
3.1	2-342/00	ASSY, SPOUT & BASE BRAZE, ROUND, JOLIE, BRAZE	1
3.2	11912/00	THREADED RING, BASE, DECK TUB SPOUT, ROUND, JOLIE	1
3.3	11911/00	DECORATIVE RING, BASE, DECK TUB SPOUT, ROUND	1
3.4	11941/00	THREADED AERATOR HOUSING, BOTTOM	1
3.5	11904/00	CENTER RING, AERATOR HOUSING, WALL/TUB SPOUT, JOLIE	1
3.6	11905/00	DECORATIVE WASHER, AERATOR HOUSING, WALL/TUB SPOUT	1
3.7	P05024	AERATOR CACHE COIN SLOT, M21.5X1.0 FULL FLOW	1
3.8	92127	SET SCREW, CUP PT, 1/4"-20 X 5/16" L, SS	1
3.9	90034	O-RING, 2-1/8" ID X 2-1/4" OD X 1/16" THK, AS-568-034	1
4	4-579/00	HAND SHOWER HEAD, HOSE, ELBOW, CYLINDER	1
4.1	3-049/00	ASSY, HOSE KIT, HANDSHOWER	1
4.2	3-050/00	ELBOW ASSEMBLY	1
4.3	3-471/00	ASSY, ROUND HANDSHOWER, CONTEMPORARY	1

D3	A	UPDATE HAND SHOWER SUBASSY	10/13/2020	AMM
ZONE	REV.	DESCRIPTION	DATE	APPROVED
REVISIONS				

1261 LOGAN AVENUE
COSTA MESA, CALIFORNIA 92626
PHONE: 714.361.4800
FAX: 714.617.3120

PHYLIRICH[®]
Defining Luxury Since 1959

PROPRIETARY AND CONFIDENTIAL
THE INFORMATION CONTAINED IN THIS DRAWING IS THE SOLE PROPERTY OF PHYLIRICH. ANY REPRODUCTION IN PART OR AS A WHOLE WITHOUT THE WRITTEN PERMISSION OF PHYLIRICH IS PROHIBITED.
DO NOT SCALE DRAWING

ASSY, DECK TUB SET W/ HANDSHOWER, ROUND JOLIE

SIZE A	ASM/PRT NO. 222-48/00	REV A
SCALE: 1:5	WEIGHT: lbs.	SHEET 1 OF 2