

- NOTE(S):
1. PART NUMBER, "/00" DENOTES PART SHALL HAVE FINISH.
  2. APPLY NSF-COMPLIANT GREASE TO ANY O-RING, SEALING JOINTS, AND/OR PIVOTAL POINTS.
  3. APPLY NSF-COMPLIANT LOCTITE TO THREADED AREA.
  4. APPLY NSF-COMPLIANT REMOVABLE (BLUE) LOCTITE TO THREADED AREA.
  5. SILVER SOLDER JOINTS SHALL BE FULLY WETTED VIA CAPILLARY ACTION AND COMPLETELY NON-POROUS.

- G
- L
- B
- S

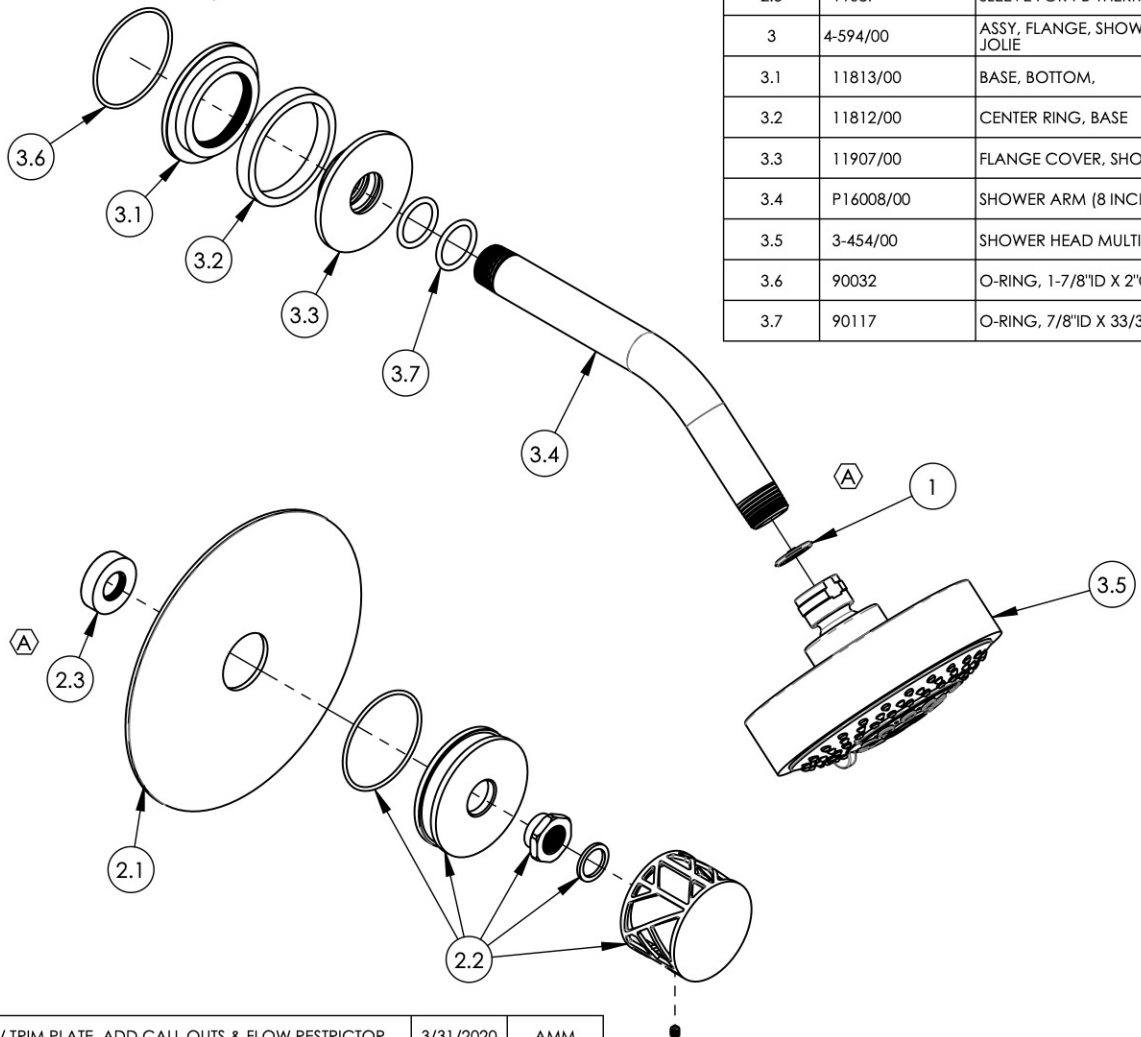

ITEM NO.	PART NUMBER	DESCRIPTION	QTY.
1	11432	1.75 GPM FLOW REGULATOR	1
2	4-592/00	ASSY, SHOWER TRIM, SINGLE HANDLE, ROUND, JOLIE	1
2.1	10443/00	TRIM PLATE 6" ROUND, BASIC II	1
2.2	3-605/00	ASSY, ROUND HANDLE & BASE, CAGE DESIGN, JOLIE	1
2.3	11087	SLEEVE FOR PB-THERM PLATE	1
3	4-594/00	ASSY, FLANGE, SHOWER ARM, SHOWER HEAD, ROUND, JOLIE	1
3.1	11813/00	BASE, BOTTOM,	1
3.2	11812/00	CENTER RING, BASE	1
3.3	11907/00	FLANGE COVER, SHOWER ARM, ROUND, JOLIE	1
3.4	P16008/00	SHOWER ARM (8 INCH)	1
3.5	3-454/00	SHOWER HEAD MULTI. FUNC. CONTEMP.	1
3.6	90032	O-RING, 1-7/8"ID X 2"OD X 1/16"THK., AS-568-032	1
3.7	90117	O-RING, 7/8"ID X 33/32"THK., AS-568-117	2

ALL	A	UPDATE TEMPLATE/ TRIM PLATE, ADD CALL OUTS & FLOW RESTRICTOR	3/31/2020	AMM
ZONE	REV.	DESCRIPTION	DATE	APPROVED
REVISIONS				

1261 LOGAN AVENUE  
COSTA MESA, CALIFORNIA 92626  
PHONE: 714.361.4800  
FAX: 714.617.3120

**PHYLIRICH**<sup>®</sup>  
Defining Luxury Since 1959

**PROPRIETARY AND CONFIDENTIAL**  
THE INFORMATION CONTAINED IN THIS DRAWING IS THE SOLE PROPERTY OF PHYLIRICH. ANY REPRODUCTION IN PART OR AS A WHOLE WITHOUT THE WRITTEN PERMISSION OF PHYLIRICH IS PROHIBITED.  
**DO NOT SCALE DRAWING**

ASSY, PRESSURE BALANCE SHOWER SET

SIZE <b>A</b>	ASM/PRT NO. 222-21/00	REV A
SCALE: 1:3.5	WEIGHT: lbs.	SHEET 1 OF 2