

NOTE(S):  
 1. APPLY NSF COMPLIANT GREASE TO ANY O-RING, SEALING JOINTS, AND/OR PIVOTAL POINTS.

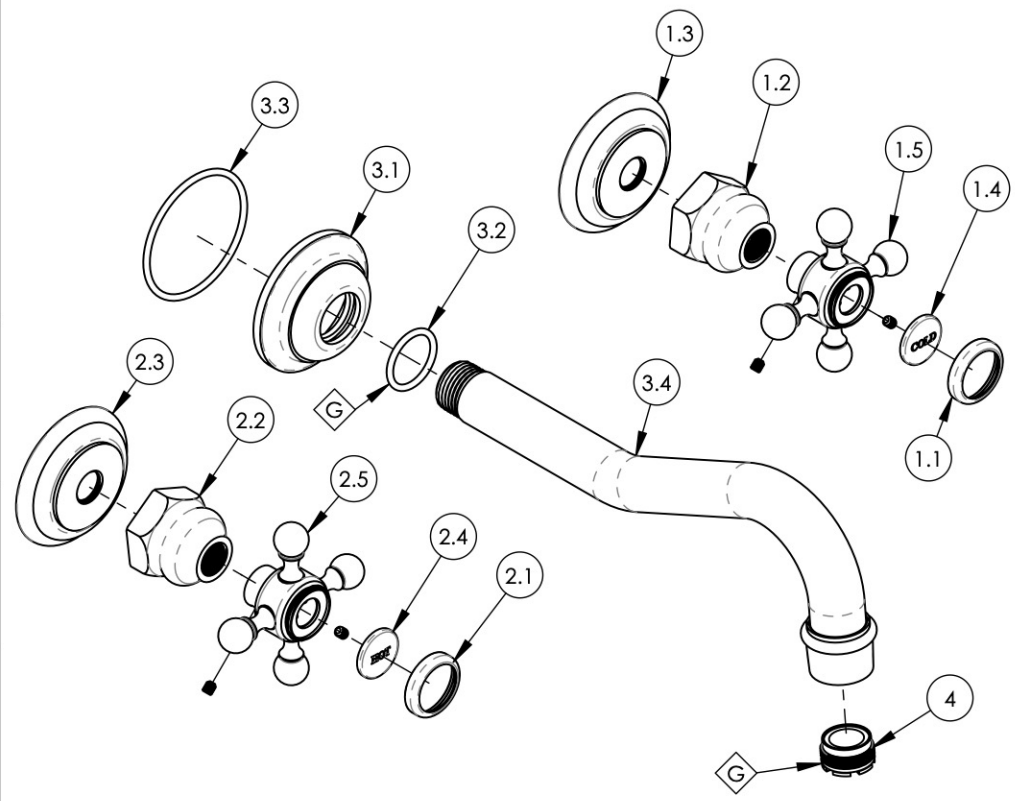

ITEM NO.	PART NUMBER	DESCRIPTION	QTY.
1	3-142C/00	CROSS HANDLE, WALL/SHOWER, 500 SERIES	1
1.1	10538/00	CAP RING FOR 500 SERIES BUTTON	1
1.2	10621/00	BASE HUB NUT	1
1.3	10618/00	ESCUTCHEON, TRADITIONAL 500	1
1.4	11098	PLASTIC BUTTON, COLD	1
1.5	2-180/00	SUB ASSY. CROSS HANDLE HUB	1
2	3-142H/00	CROSS HANDLE, WALL/SHOWER, 500 SERIES	1
2.1	10538/00	CAP RING FOR 500 SERIES BUTTON	1
2.2	10621/00	BASE HUB NUT	1
2.3	10618/00	ESCUTCHEON, TRADITIONAL 500	1
2.4	11099	PLASTIC BUTTON, HOT	1
2.5	2-180/00	SUB ASSY. CROSS HANDLE HUB	1
3	3-390/00	WALL SPOUT, HENRI SERIES	1
3.1	11158/00	FLANGE, WALL TUB	1
3.2	90118	O-RING, 7/8"ID X 1-1/16"OD X 3/32"THK., AS-568-118	1
3.3	90137	O-RING, 2-1/16"ID X 3/32"THK., AS-568-137	1
3.4	2-108/00	SUB. ASSY, WALL SPOUT	1
4	P05024	AERATOR CACHE COIN SLOT, M21.5X1.0 FULL FLOW	1

ALL	B	UPDATE TEMPLATE, HANDLE SET SCREW ORIENTATION, ADD CALL OUTS	4/23/2020	AMM
ZONE	REV.	DESCRIPTION	DATE	APPROVED
REVISIONS				

1261 LOGAN AVENUE  
 COSTA MESA, CALIFORNIA 92626  
 PHONE: 714.361.4800  
 FAX: 714.617.3120

**PHYLIRICH**<sup>®</sup>  
 Defining Luxury Since 1959

**PROPRIETARY AND CONFIDENTIAL**  
 THE INFORMATION CONTAINED IN THIS DRAWING IS THE SOLE PROPERTY OF PHYLIRICH. ANY REPRODUCTION IN PART OR AS A WHOLE WITHOUT THE WRITTEN PERMISSION OF PHYLIRICH IS PROHIBITED.

-	-	INTERPRET GEOMETRIC DIMENSIONING & TOLERANCING IN ACCORDANCE WITH ASME Y14.5-2009 & ASME Y14.41-2003 STANDARDS, UNLESS OTHERWISE SPECIFIED. DIMENSIONS ARE IN INCHES. TOLERANCES ARE:		
NEXT ASSY	USED ON	<b>FRACTIONS</b> ±1/16"	<b>DECIMALS</b> X.X: ±.1 X.XX: ±.01 X.XXX: ±.005	<b>ANGULAR</b> ±2°
APPLICATION		NAME	DATE	
MATERIAL		DRAWN	LLO	11/2/2015
FINISH		CHECKED	GRE	
<b>DO NOT SCALE DRAWING</b>				

**WALL TUB SET, CROSS HANDLES, HENRI SERIES**

SIZE	ASM/PRT NO.	REV
<b>A</b>	161-56/00	<b>B</b>
SCALE: 1:3	WEIGHT: lbs.	SHEET 1 OF 2